

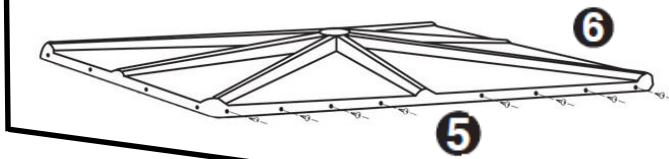

4'x8' BOW BLYND ASSEMBLY INSTRUCTIONS

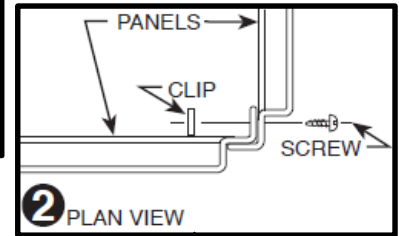

NOTE: Window is pre-bent to insure stability in window track.

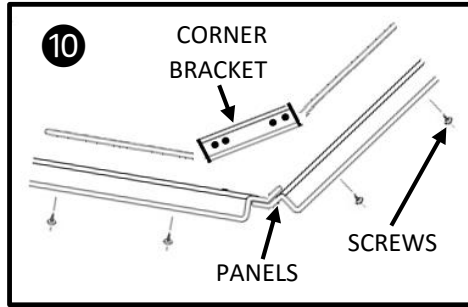
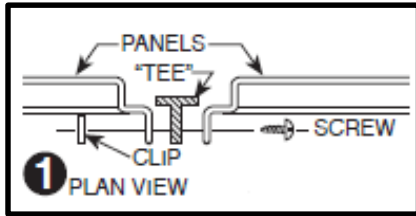
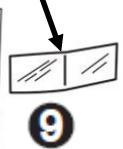

NOTE: When securing walls, start with the top screw and work downward. Be sure not to over torque screws and clips.

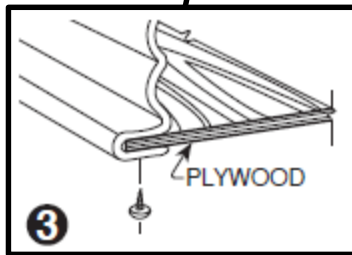

NOTE: Door comes installed. Shown off for clarity of other assemblies.

NOTE: Door panel may be moved to any side when utilized as a ground blynd.

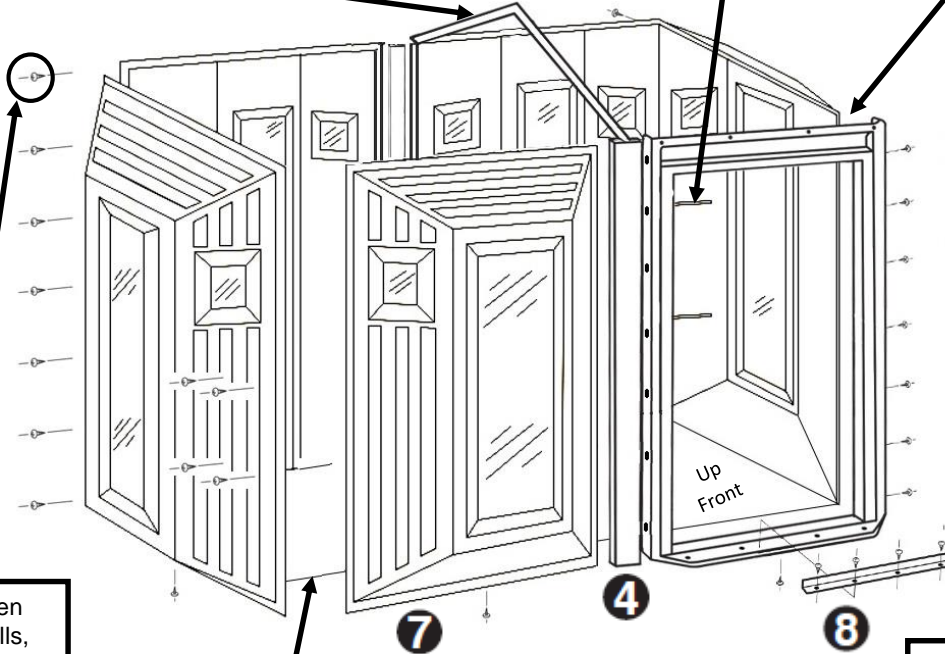

a product of

PLASTIC VACUUM FORMING, INC.

12103 Radium Dr. • San Antonio • Texas • 78216 • 210-344-8531 • 1-800-458-0263

HELPFUL HINT:

It is recommended that you have an assistant help you with the assembly of the Bow Blynd.

NOTE:

Anchoring system is owner's responsibility.

Plastic Vacuum Forming, Inc. assumes no liability for injury or damage to persons or property resulting from the use of its products or services. The products that we sell must be assembled, installed, anchored and used with care, caution, and common sense.

Please read all instructions before starting assembly.

RECOMMENDED TOOLS:

Cordless drill

Phillips Head Bit

BOXED:

Item List:

- | | |
|------------------------------------|---|
| (1) Door panel with full size door | (1) Package screws & clips |
| (5) Side walls | (2) Aluminum T-bars (w/ L Bracket supports at bottom) |
| (1) 4' x 8' roof | (1) Roof support brace (connects to top of T-bars) |
| (1) 4' x 8' plywood floor | (6) Wall support corner brackets |
| (1) Door window | |
-

ASSEMBLY INSTRUCTIONS:

- 1 Join back panels and front panels together with T-bar sandwiched between. Use seven screws and clips per panel assembly. See detail.
- 2 Place back panel between helper or a stable object. Overlap corner panels as shown and secure each side panel to back panel with seven screws and clips.
- 3 Slide plywood into bottom of back and side panel slots. **NOTE:** Plywood must be positioned with side marked "UP" as shown. Extend the life of the floor with an exterior oil-based paint or water seal product.
- 4 Slide front panel into position and secure to sides.
- 5 Connect roof support brace.
- 6 Position the roof over the wall flanges. From inside, push upper panel against roof flange and secure each side with screws and clips.
- 7 Turn the Bow Blynd on its side and secure plastic flanges to plywood. See illustration 3.
- 8 Line up door stop and secure to floor flange as shown with flange turned outward.
- 9 Install window with the bent side facing out.
- 10 Install wall support corner brackets with existing holes in back corners.

NOTE: Floor handle only comes with a Tower Kit. To assemble use holes provided in floor to locate and install handle. Use two 1/4"-20x1-1/4" Hex Capscrews, 5/16" fender washers, and 1/4"-20 Hex Nuts to secure.

Plastic Vacuum Forming, Inc. assumes no liability for injury or damage to persons or property resulting from the use of its products or services. The products that we sell must be assembled, installed, anchored and used with care, caution, and common sense.

Please read all instructions before starting assembly.

DOWNLOAD AT WWW.BLYND.COM